

5/28/99

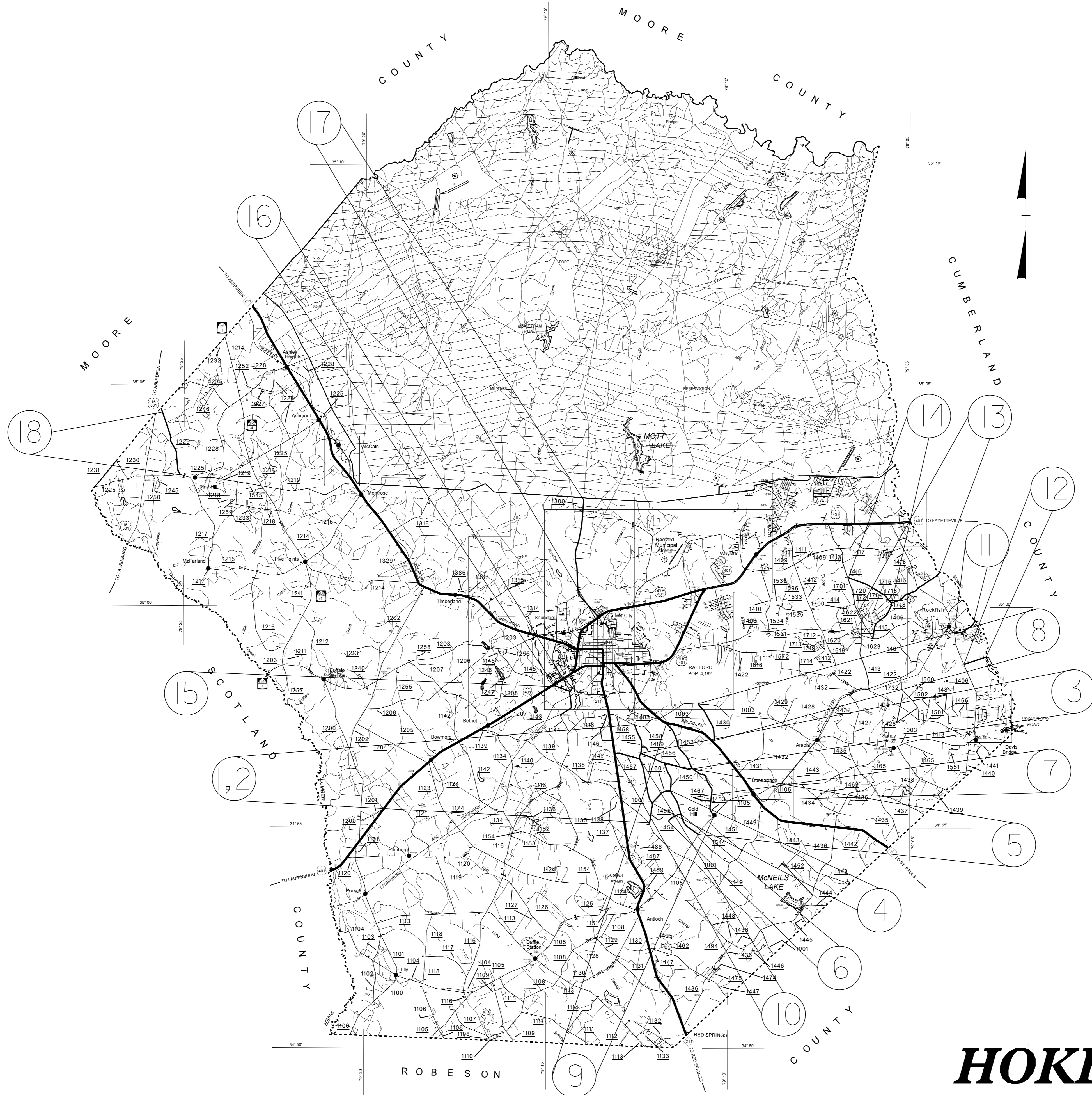

HOKE COUNTY

SYSTEMS DIVISION

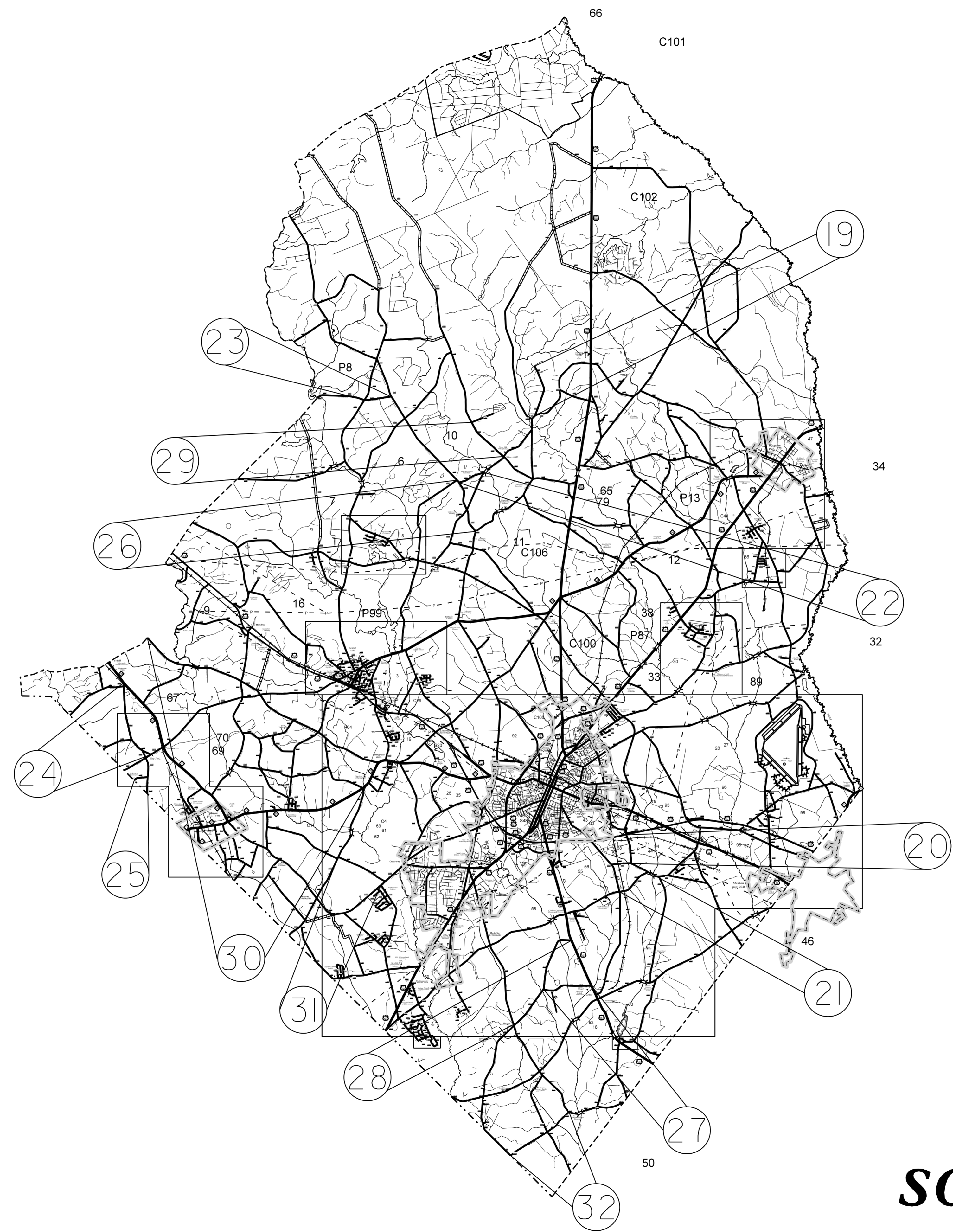

SCOTLAND COUNTY

SCOTLAND COUNTY, NC
2017 CPT. 08.18.20472, 2017 CPT. 08.18.20832

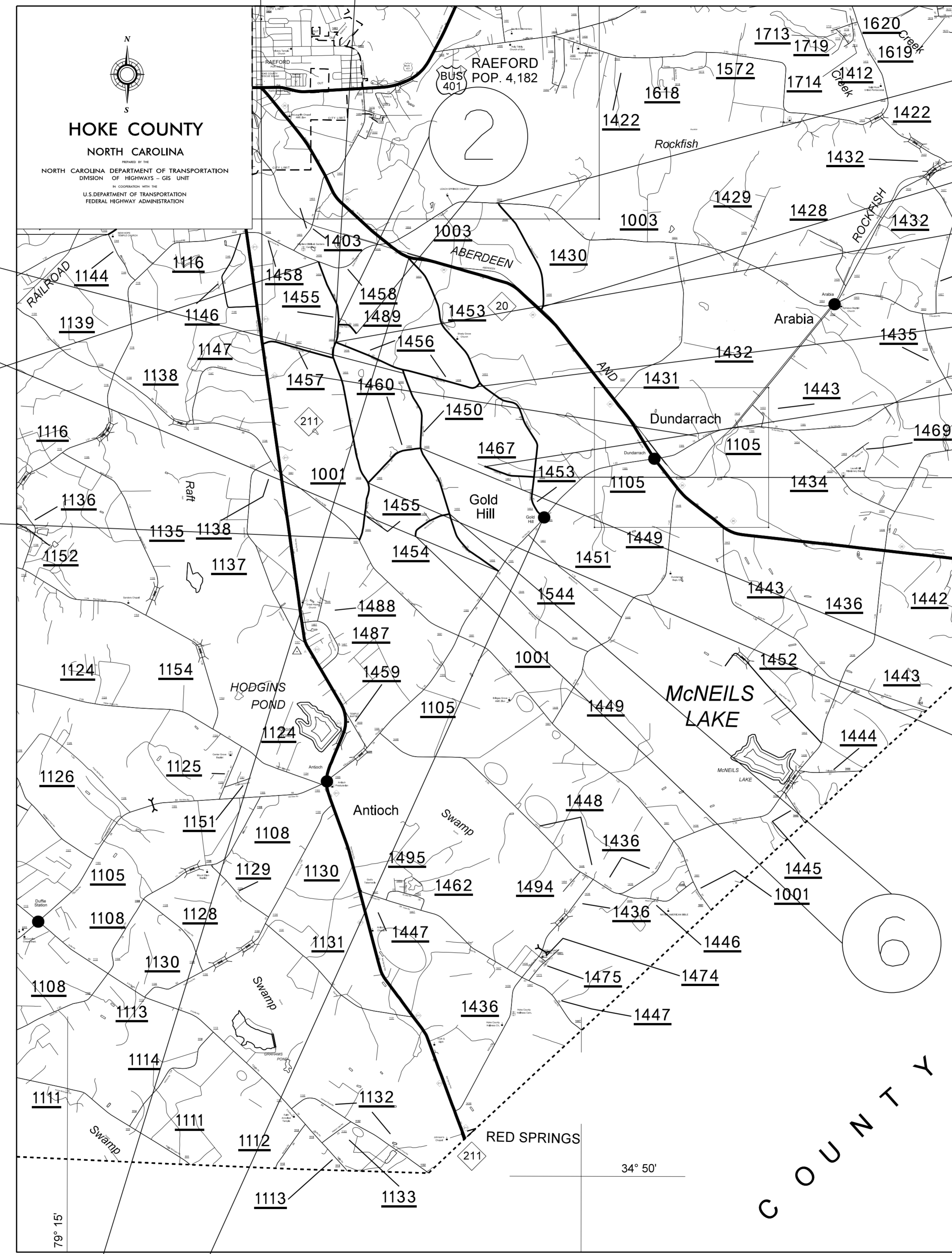

5

1

10

2

8

3

7

4

6

9

C O U N T Y

2017CPT.08.18.20472, 2017CPT.08.18.20832

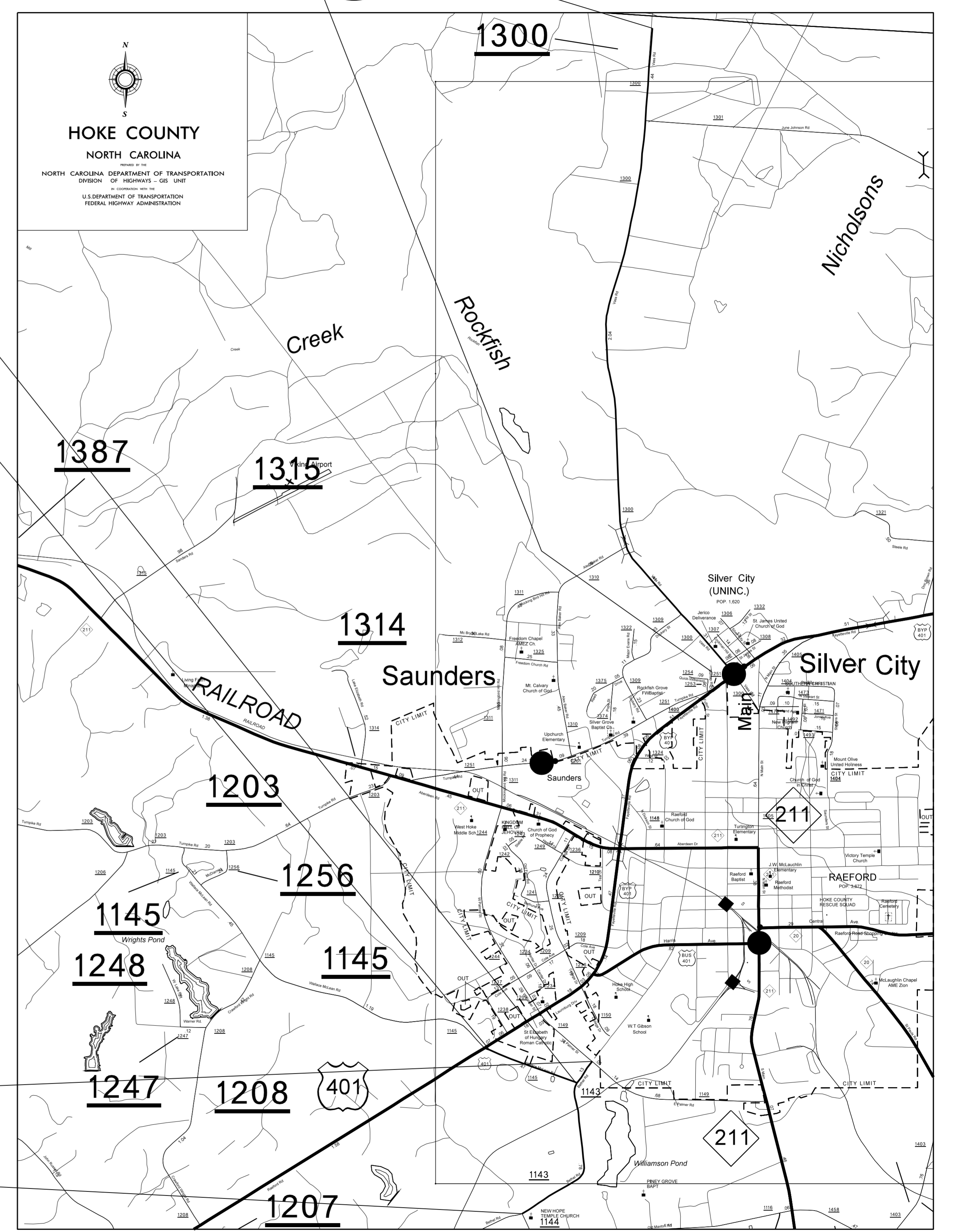
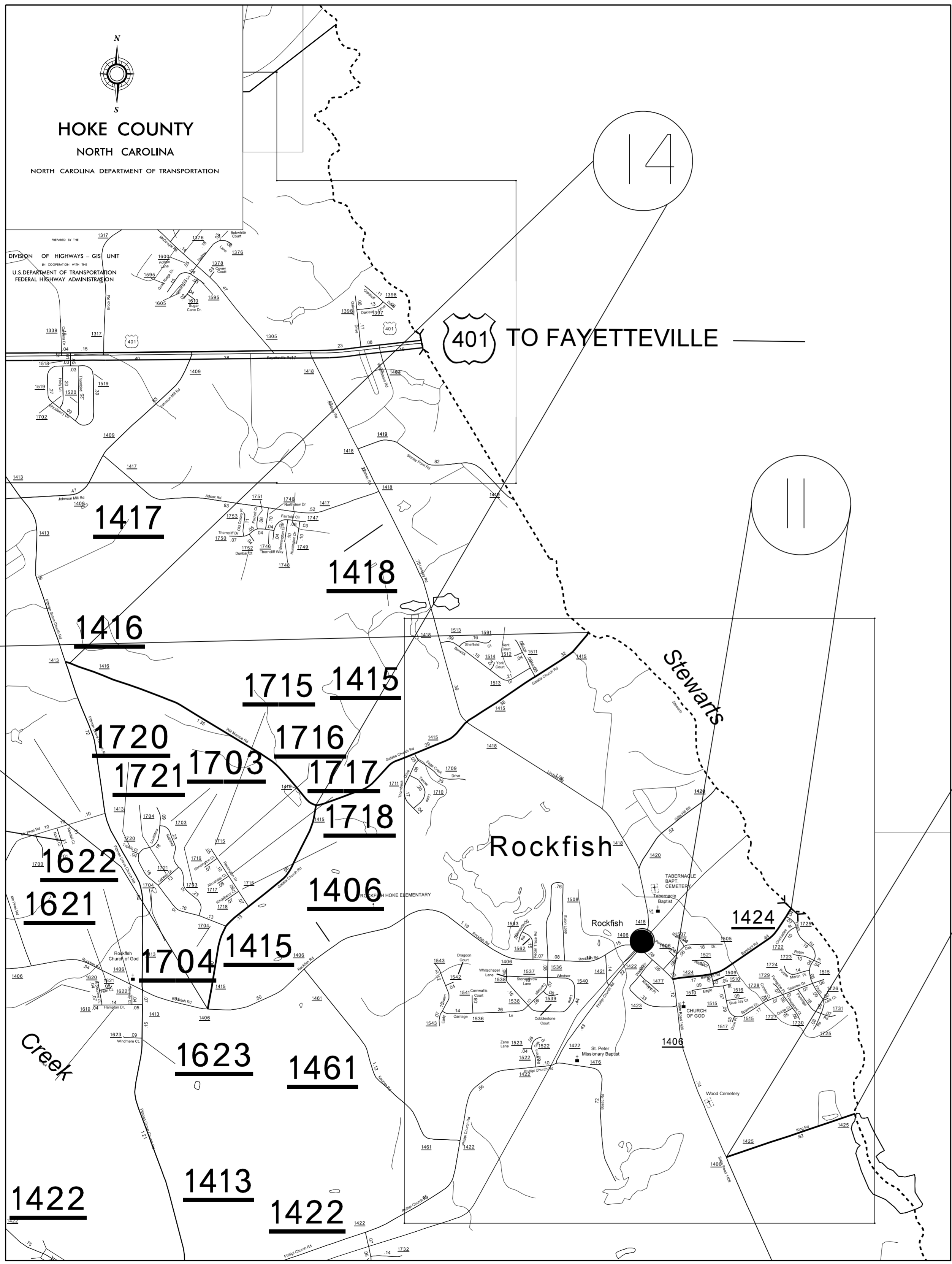

SECTION 17

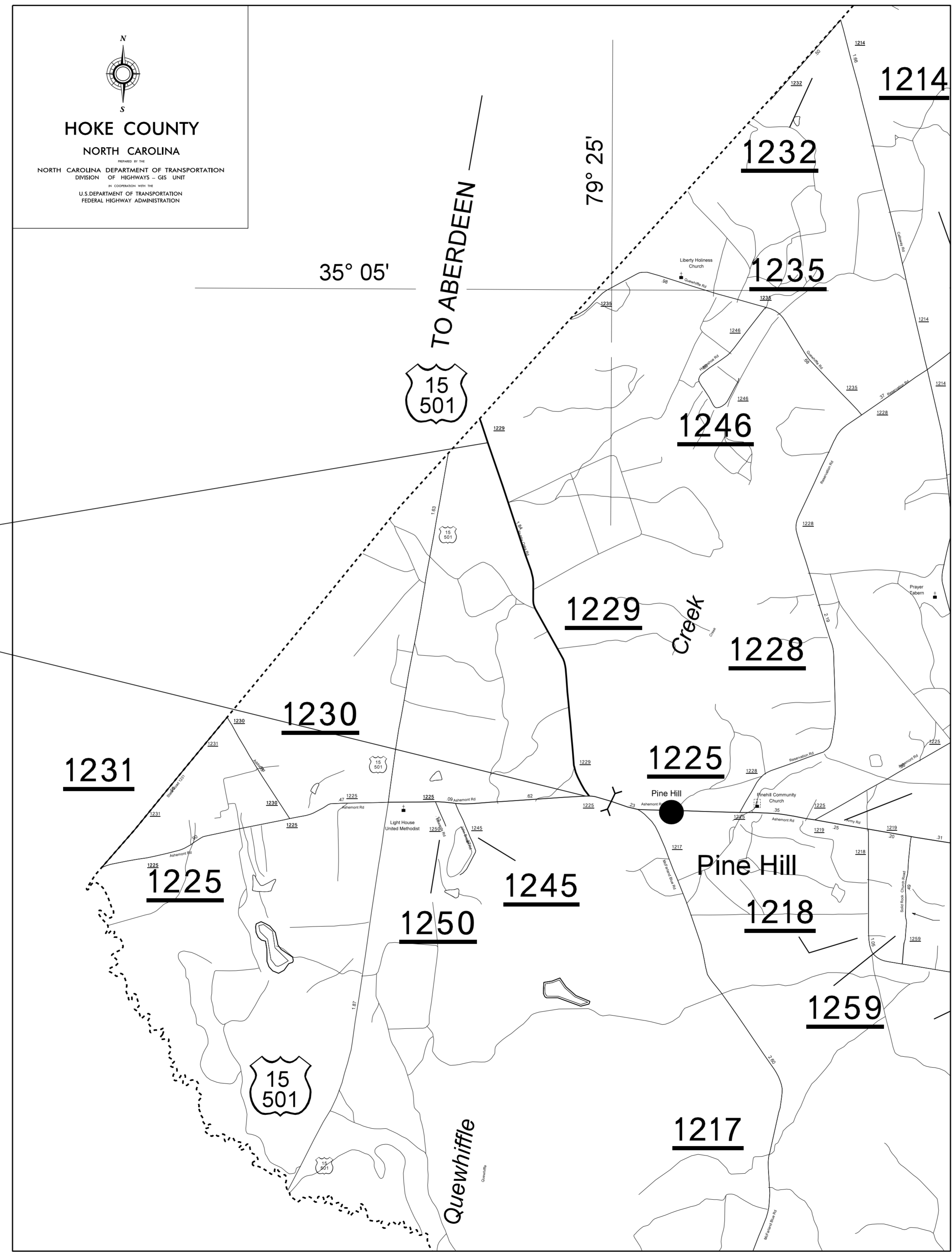

04/03/2017 10:51 AM \$\$\$\$\$\$

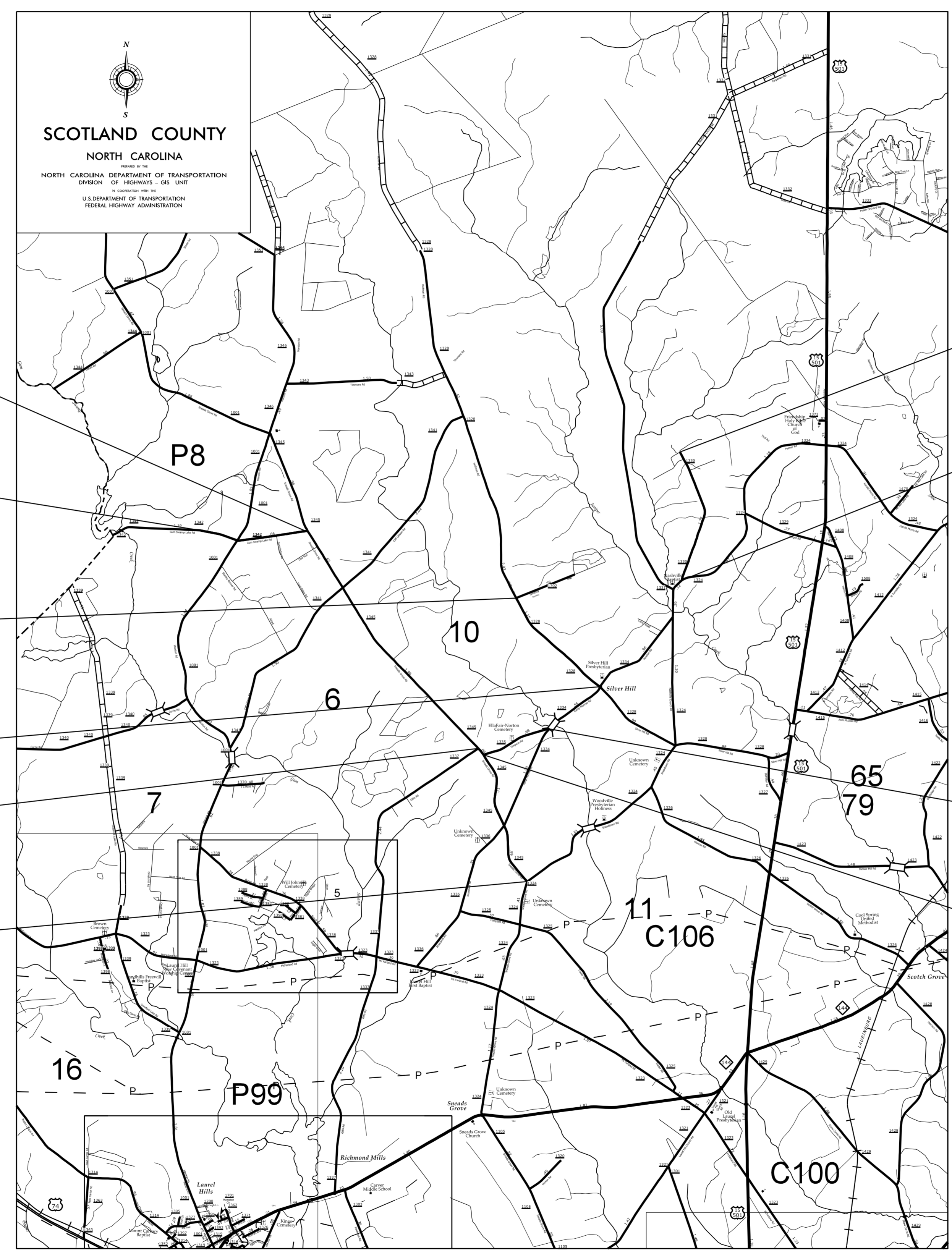

23

19

29

26

22

0140310
UNIVERSITY OF NORTH CAROLINA
STATE COLLEGE OF ENGINEERING
TRANSPORTATION CENTER

PROJECT NO.	SHEET NO.	TOTAL NO.
2017CPT.08.18.20472	8	
2017CPT.08.18.20832		

SUMMARY OF QUANTITIES

PROJECT NO	COUNTY	MAP NO	ROUTE	DESCRIPTION	LANES	LANE TYPE	LENGTH MI	WIDTH FT	ASPHALT SURFACE TREATMENT, DOUBLE SEAL SY	EMULSION FOR ASPHALT SURFACE TREATMENT GAL	BLOTTING SAND TON
2017CPT.08.18.20472	Hoke	1	SR 1455 (HAIRE RD)	FROM SR 1001 (SHANNON RD) TO SR 1458 SCOTT CURRIE RD)	2	2WU	2.68	18	28,301.00	15,566	
TOTAL FOR MAP NO. 1							2.68		28,301.00	15,566	
2017CPT.08.18.20472	Hoke	2	SR 1489 (PINE TREE LN)	FROM SR 1455 (HAIRE RD) TO DEAD END	2	2WU	0.2	18	2,112.00	1,162	
TOTAL FOR MAP NO. 2							0.2		2,112.00	1,162	
2017CPT.08.18.20472	Hoke	3	SR 1456 (SHANKLE RD)	FROM SR 1455 (HAIRE RD) TO SR 1453 (GOLD HILL RD)	2	2WU	1.42	20	16,661.00	9,165	
TOTAL FOR MAP NO. 3							1.42		16,661.00	9,165	
2017CPT.08.18.20472	Hoke	4	SR 1460 (CONOLY RD)	FROM SR 1450 (MCPHAUL RD) TO SR 1455 (HAIRE RD)	2	2WU	0.61	20	7,157.00	3,937	
TOTAL FOR MAP NO. 4							0.61		7,157.00	3,937	
2017CPT.08.18.20472	Hoke	5	SR 1450 (MCPHAUL RD)	FROM SR 1105 (OLD WIRE RD) TO SR 1456 (SHANKLE RD)	2	2WU	2.15	20	25,227.00	13,875	
TOTAL FOR MAP NO. 5							2.15		25,227.00	13,875	
2017CPT.08.18.20472	Hoke	6	SR 1454 (MCCORMICK RD)	FROM SR 1450 (MCPHAUL RD) TO DEAD END	2	2WU	0.4	18	4,224.00	2,325	
TOTAL FOR MAP NO. 6							0.4		4,224.00	2,325	
2017CPT.08.18.20472	Hoke	7	SR 1467 (LEACH RD)	FROM SR 1453 (GOLD HILL RD) TO DEAD END	2	2WU	0.47	18	4,963.00	2,730	
TOTAL FOR MAP NO. 7							0.47		4,963.00	2,730	
2017CPT.08.18.20472	Hoke	8	SR 1430 (UPCHURCH RD)	FROM NC 20 TO SR 1004 (ARABIA RD)	2	2WU	1.11	20	13,024.00	7,165	
TOTAL FOR MAP NO. 8							1.11		13,024.00	7,165	
2017CPT.08.18.20472	Hoke	9	SR 1453 (GOLD HILL RD)	FROM SR 1105 (OLD WIRE RD) TO NC 20	2	2WU	2.89	18	30,518.00	16,785	
TOTAL FOR MAP NO. 9							2.89		30,518.00	16,785	
2017CPT.08.18.20472	Hoke	10	SR 1457 (CICERO BEATTY RD)	FROM NC 211 TO SR 1455 (HAIRE RD)	2	2WU	0.68	18	7,181.00	3,950	
TOTAL FOR MAP NO. 10							0.68		7,181.00	3,950	
2017CPT.08.18.20472	Hoke	11	SR 1424 (BAREFOOT RD)	FROM CUMBERLAND CO LINE TO SR 1406 (ROCKFISH RD)	2	2WU	0.66	18	6,970.00	3,835	
TOTAL FOR MAP NO. 11							0.66		6,970.00	3,835	
2017CPT.08.18.20472	Hoke	12	SR 1425 (KING RD)	FROM CUMBERLAND CO LINE TO SR 1406 (ROCKFISH RD)	2	2WU	0.62	22	8,002.00	4,402	
TOTAL FOR MAP NO. 12							0.62		8,002.00	4,402	
2017CPT.08.18.20472	Hoke	13	SR 1415 (GALATIA CH RD)	FROM SR 1406 (ROCKFISH RD) TO CUMBERLAND CO LINE	2	2WU	2.6	20	30,507.00	16,780	
TOTAL FOR MAP NO. 13							2.6		30,507.00	16,780	
2017CPT.08.18.20472	Hoke	14	SR 1416 (WILL MONROE RD)	FROM SR 1413 (PITTMAN GROVE CH RD) TO SR 1415 (GALATIA CH RD)	2	2WU	1.34	20	15,273.00	8,650	
TOTAL FOR MAP NO. 14							1.34		15,273.00	8,650	
2017CPT.08.18.20472	Hoke	15	SR 1143 (BETHEL RD)	FROM SR 1144 (FREEDOM RD) TO SR 1149 (E. PALMER RD)	2	2WU	0.9	18	9,504.00	5,228	
TOTAL FOR MAP NO. 15							0.9		9,504.00	5,228	
2017CPT.08.18.20472	Hoke	16	SR 1145 (WALLACE MCLEAN RD)	FROM US 401 TO SR 1143 (BETHEL RD)	2	2WU	0.47	18	4,963.00	2,730	
TOTAL FOR MAP NO. 16							0.47		4,963.00	2,730	
2017CPT.08.18.20472	Hoke	17	SR 1300 (VASS RD)	FROM US 401 TO FT BRAGG	2	2WU	3.27	18	34,531.00	18,993	25
TOTAL FOR MAP NO. 17							3.27		34,531.00	18,993	25
2017CPT.08.18.20472	Hoke	18	SR 1229 (STUBBY OAKS RD)	FROM SR 1225 (ASHEMONT RD) TO MOORE COUNTY LINE	2	2WU	1.84	20	21,600.00	11,880	
TOTAL FOR MAP NO. 18							1.84		21,600.00	11,880	
TOTAL FOR PROJ NO. 2017CPT.08.18.20472							24.31		270,718.00	149,158	25
2017CPT.08.18.20832	Scotland	19	SR 1330 (MCCALLISTER RD)	FRO SR 1324 (PALMER RD) TO DEAD END	2	2WU	1.28	20	14,898.00	8,194	
TOTAL FOR MAP NO. 19							1.28		14,898.00	8,194	
2017CPT.08.18.20832	Scotland	20	SR 1323 (HIGHLAND RD)	FROM SR 1609 (HARRY MALLOY RD) TO US 74 BYPASS	2	2WU	0.72	20	9,608.00	5,285	
TOTAL FOR MAP NO. 20							0.72		9,608.00	5,285	
2017CPT.08.18.20832	Scotland	21	SR 1614 (OLD BARNES BRIDGE ROAD)	FROM SR 1609 (HARRY MALLOT ROAD) TO SR 1601 (OLD JOHNS ROAD)	2	2WU	0.87	20	10,903.00	5,997	
TOTAL FOR MAP NO. 21							0.87		10,903.00	5,997	
2017CPT.08.18.20832	Scotland	22	SR 1335 (SIMPSON ROAD)	FROM SR 1345 (SNEADS GROVE ROAD) SR 1334 (CAMP MONROE MILL ROAD)	2	2WU	0.67	20	8,500.00	4,675	
TOTAL FOR MAP NO. 22							0.67		8,500.00	4,675	
2017CPT.08.18.20832	Scotland	23	SR 1342 (GUM SWAMP LAKE ROAD)	FROM SR 1345 (SNEADS GROVE ROAD) TO END OF PVMT.	2	2WU	0.99	20	11,600.00	6,380	
TOTAL FOR MAP NO. 23							0.99		11,600.00	6,380	
2017CPT.08.18.20832	Scotland	24	SR 1158 (TABERNACLE ROAD)	FROM NC 381 TO SR 1152 (OLD WIRE ROAD)	2	2WU	1.92	20	26,949.00	14,822	
TOTAL FOR MAP NO. 24							1.92		26,949.00	14,822	
2017CPT.08.18.20832	Scotland	25	SR 1160 (PEARSON ROAD)	FROM SR 1159 (HUNSUCKER ROAD) TO S. C. LINE	2	2WU	0.36	20	4,292.00	2,361	
TOTAL FOR MAP NO. 25							0.36		4,292.00	2,361	
2017CPT.08.18.20832	Scotland	26	SR 1345 (SNEADS GROVE ROAD)	FROM SR 1324 (SNEADTOWN ROAD) TO SR 1337 (GILLIS ROAD)	2	2WU	1.38	20	15,794.00	8,687	
TOTAL FOR MAP NO. 26							1.38		15,794.00	8,687	
2017CPT.08.18.20832	Scotland	27	SR 1620 (JERUSALEM ROAD)	FROM US 501 TO SR 1621 (MCQUEEN ROAD)	2	2WU	1.19	20	15,073.00	8,291	
TOTAL FOR MAP NO. 27							1.19		15,073.00	8,291	
2017CPT.08.18.20832	Scotland	28	SR 1621 (MCQUEEN ROAD)	FROM SR 1615 (HASTY ROAD) TO US 501	2	2WU	2.68	20	40,685.00	22,377	
TOTAL FOR MAP NO. 28							2.68		40,685.00	22,377	
2017CPT.08.18.20832	Scotland	29	SR 1328 (HOFFMAN ROAD)	FROM SR 1334 (CAMP MONROE ROAD) TO SR 1702 (SPRADLEY TRAIL)	2	2WU	1.15	20	13,436.00	7,390	
TOTAL FOR MAP NO. 29							1.15		13,436.00	7,390	
2017CPT.08.18.20832	Scotland	30	SR 1126 (ROCKINGHAM ROAD)	FROM NC 79 TO RICHMOND COUNTY LINE	2	2WU	6.55	20	84,326.00	46,380	25
TOTAL FOR MAP NO. 30							6.55		84,326.00	46,380	25
2017CPT.08.18.20832	Scotland	31	SR 1120 (SIDNEY BEAN RD)	FROM SR 1108 (X-RAY RD) TO SR 1128 (OLD STAGE RD)	2	2WU	1.28	18	13,520.00	7,436	
TOTAL FOR MAP NO. 31							1.28		13,520.00	7,436	
2017CPT.08.18.20832	Scotland	32	SR 1624 (GRAHAM RD)	FROM SR 1615 (HASTY RD) TO SR 1625 (STATE LINE RD)	2	2WU	1.77	20	20,770.00	11,425	
TOTAL FOR MAP NO. 32							1.77		20,770.00	11,425	
TOTAL FOR PROJ NO. 2017CPT.08.18.20832							22.81		290,354.00	159,700	25
GRAND TOTAL							47.12		561,072.00	308,858	50

PROJECT NO.	SHEET NO.	TOTAL NO.
2017CPT.08.18.20472	9	
2017CPT.08.18.20832		

THERMOPLASTIC AND PAINT QUANTITIES

PROJECT NO	COUNTY	MAP NO	ROUTE	DESCRIPTION	LANES	LANE TYPE	LENGTH	WIDTH	441300000-E	445700000-N	470500000-E	471000000-E	472100000-E	481000000-E	481000000-E	
									WORK ZONE ADVANCE/GENERAL WARNING SIGNING	TEMPORARY TRAFFIC CONTROL	16" X 120 M WHITE THERMO	24" X 120 M WHITE THERMO	THERMO RXR 120 M	4" WHITE PAINT	4" YELLOW PAINT	
									SF	LS	LF	LF	EA	LF	LF	
2017CPT.08.18.20472	Hoke	1	SR 1455 (HAIRE RD)	FROM SR 1001 (SHANNON RD) TO SR 1458 SCOTT CURRIE RD)	2	2WU	2.68	18	301						57,674	45,292
TOTAL FOR MAP NO. 1									301					57,674	45,292	
2017CPT.08.18.20472	Hoke	2	SR 1489 (PINE TREE LN)	FROM SR 1455 (HAIRE RD) TO DEAD END	2	2WU	0.2	18	23							
TOTAL FOR MAP NO. 2									23							
2017CPT.08.18.20472	Hoke	3	SR 1456 (SHANKLE RD)	FROM SR 1455 (HAIRE RD) TO SR 1453 (GOLD HILL RD)	2	2WU	1.42	20	160						30,558	23,998
TOTAL FOR MAP NO. 3									160					30,558	23,998	
2017CPT.08.18.20472	Hoke	4	SR 1460 (CONOLY RD)	FROM SR 1450 (MCPHAUL RD) TO SR 1455 (HAIRE RD)	2	2WU	0.61	20	69						13,127	10,309
TOTAL FOR MAP NO. 4									69					13,127	10,309	
2017CPT.08.18.20472	Hoke	5	SR 1450 (MCPHAUL RD)	FROM SR 1105 (OLD WIRE RD) TO SR 1456 (SHANKLE RD)	2	2WU	2.15	20	241						46,268	36,335
TOTAL FOR MAP NO. 5									241					46,268	36,335	
2017CPT.08.18.20472	Hoke	6	SR 1454 (MCCORMICK RD)	FROM SR 1450 (MCPHAUL RD) TO DEAD END	2	2WU	0.4	18	45							
TOTAL FOR MAP NO. 6									45							
2017CPT.08.18.20472	Hoke	7	SR 1467 (LEACH RD)	FROM SR 1453 (GOLD HILL RD) TO DEAD END	2	2WU	0.47	18	53							
TOTAL FOR MAP NO. 7									53							
2017CPT.08.18.20472	Hoke	8	SR 1430 (UPCHURCH RD)	FROM NC 20 TO SR 1004 (ARABIA RD)	2	2WU	1.11	20	125						23,887	18,759
TOTAL FOR MAP NO. 8									125					23,887	18,759	
2017CPT.08.18.20472	Hoke	9	SR 1453 (GOLD HILL RD)	FROM SR 1105 (OLD WIRE RD) TO NC 20	2	2WU	2.89	18	324						62,193	48,841
TOTAL FOR MAP NO. 9									324					62,193	48,841	
2017CPT.08.18.20472	Hoke	10	SR 1457 (CICERO BEATTY RD)	FROM NC 211 TO SR 1455 (HAIRE RD)	2	2WU	0.68	18	77						14,634	11,492
TOTAL FOR MAP NO. 10									77					14,634	11,492	
2017CPT.08.18.20472	Hoke	11	SR 1424 (BAREFOOT RD)	FROM CUMBERLAND CO LINE TO SR 1406 (ROCKFISH RD)	2	2WU	0.66	18	74						14,203	11,154
TOTAL FOR MAP NO. 11									74					14,203	11,154	
2017CPT.08.18.20472	Hoke	12	SR 1425 (KING RD)	FROM CUMBERLAND CO LINE TO SR 1406 (ROCKFISH RD)	2	2WU	0.62	22	70						13,342	10,478
TOTAL FOR MAP NO. 12									70					13,342	10,478	
2017CPT.08.18.20472	Hoke	13	SR 1415 (GALATIA CH RD)	FROM SR 1406 (ROCKFISH RD) TO CUMBERLAND CO LINE	2	2WU	2.6	20	292						55,952	43,940
TOTAL FOR MAP NO. 13									292					55,952	43,940	
2017CPT.08.18.20472	Hoke	14	SR 1416 (WILL MONROE RD)	FROM SR 1413 (PITTMAN GROVE CH RD) TO SR 1415 (GALATIA CH RD)	2	2WU	1.34	20	151						28,837	22,646
TOTAL FOR MAP NO. 14									151					28,837	22,646	
2017CPT.08.18.20472	Hoke	15	SR 1143 (BETHEL RD)	FROM SR 1144 (FREEDOM RD) TO SR 1149 (E.PALMER RD)	2	2WU	0.9	18	101						19,368	15,210
TOTAL FOR MAP NO. 15									101					19,368	15,210	
2017CPT.08.18.20472	Hoke	16	SR 1145 (WALLACE MCLEAN RD)	FROM US 401 TO SR 1143 (BETHEL RD)	2	2WU	0.47	18	53						10,114	7,943
TOTAL FOR MAP NO. 16									53					10,114	7,943	
2017CPT.08.18.20472	Hoke	17	SR 1300 (VASS RD)	FROM US 401 TO FT BRAGG	2	2WU	3.27	18	367						70,370	55,263
TOTAL FOR MAP NO. 17									367					70,370	55,263	
2017CPT.08.18.20472	Hoke	18	SR 1229 (STUBBY OAKS RD)	FROM SR 1225 (ASHEMONT RD) TO MOORE COUNTY LINE	2	2WU	1.84	20	207						39,597	31,096
TOTAL FOR MAP NO. 18									207	*				39,597	31,096	
TOTAL FOR PROJ NO. 2017CPT.08.18.20472									2,733	1				500,124	392,756	
892,880																
2017CPT.08.18.20832	Scotland	19	SR 1330 (MCCALLISTER RD)	FRO SR 1324 (PALMER RD) TO DEAD END	2	2WU	1.28	20	143						26,816	17,328
TOTAL FOR MAP NO. 19									143					26,816	17,328	
2017CPT.08.18.20832	Scotland	20	SR 1323 (HIGHLAND RD)	FROM SR 1609 (HARRY MALLOY RD) TO US 74 BYPASS	2	2WU	0.72	20	77		192	108	4	14,412	8,980	
TOTAL FOR MAP NO. 20									77		192	108	4	14,412	8,980	
2017CPT.08.18.20832	Scotland	21	SR 1614 (OLD BARNES BRIDGE ROAD)	FROM SR 1609 (HARRY MALLOT ROAD) TO SR 1601 (OLD JOHNS ROAD)	2	2WU	0.87	20	96		186	122	4	17,840	17,840	
TOTAL FOR MAP NO. 21									96		186	122	4	17,840	17,840	
2017CPT.08.18.20832	Scotland	22	SR 1335 (SIMPSON ROAD)	FROM SR 1345 (SNEADS GROVE ROAD) SR 1334 (CAMP MONROE MILL ROAD)	2	2WU	0.67	20	74						13,908	13,908
TOTAL FOR MAP NO. 22									74					13,908	13,908	
2017CPT.08.18.20832	Scotland	23	SR 1342 (GUM SWAMP LAKE ROAD)	FROM SR 1345 (SNEADS GROVE ROAD) TO END OF PVMT.	2	2WU	0.99	20	111						20,880	5,104
TOTAL FOR MAP NO. 23									111					20,880	5,104	
2017CPT.08.18.20832	Scotland	24	SR 1158 (TABERNACLE ROAD)	FROM NC 381 TO SR 1152 (OLD WIRE ROAD)	2	2WU	1.92	20	224		184	119	4	42,180	29,706	
TOTAL FOR MAP NO. 24									224		184	119	4	42,180	29,706	
2017CPT.08.18.20832	Scotland	25	SR 1160 (PEARSON ROAD)	FROM SR 1159 (HUNSUCKER ROAD) TO S. C. LINE	2	2WU	0.36	20	42						7,724	7,724
TOTAL FOR MAP NO. 25									42					7,724	7,724	
2017CPT.08.18.20832	Scotland	26	SR 1345 (SNEADS GROVE ROAD)	FROM SR 1324 (SNEADTOWN ROAD) TO SR 1337 (GILLIS ROAD)	2	2WU	1.38	20	152						28,428	28,428
TOTAL FOR MAP NO. 26									152					28,428	28,428	
2017CPT.08.18.20832	Scotland	27	SR 1620 (JERUSALEM ROAD)	FROM US 501 TO SR 1621 (MCQUEEN ROAD)	2	2WU	1.19	20	132						24,664	22,632
TOTAL FOR MAP NO. 27									132					24,664	22,632	
2017CPT.08.18.20832	Scotland	28	SR 1621 (MCQUEEN ROAD)	FROM SR 1615 (HASTY ROAD) TO US 501	2	2WU	2.68	20	300						56,332	26,872
TOTAL FOR MAP NO. 28									300					56,332	26,872	
2017CPT.08.18.20832	Scotland	29	SR 1328 (HOFFMAN ROAD)	FROM SR 1334 (CAMP MONROE ROAD) TO SR 1702 (SPRADLEY TRAIL)	2	2WU	1.15	20	129						24,184	17,846
TOTAL FOR MAP NO. 29									129					24,184	17,846	
2017CPT.08.18.20832	Scotland	30	SR 1126 (ROCKINGHAM ROAD)	FROM NC 79 TO RICHMOND COUNTY LINE	2	2WU	6.55	20	732						137,988	92,630
TOTAL FOR MAP NO. 30									732					137,988	92,630	
2017CPT.08.18.20832	Scotland	31	SR 1120 (SIDNEY BEAN RD)	FROM SR 1108 (JX-RAY RD) TO SR 1128 (OLD STAGE RD)	2	2WU	1.28	18	144						27,546	21,632
TOTAL FOR MAP NO. 31									144					27,546	21,632	
2017CPT.08.18.20832	Scotland	32	SR 1624 (GRAHAM RD)	FROM SR 1615 (HASTY RD) TO SR 1625 (STATE LINE RD)	2	2WU	1.77	20	199						38,090	29,913
TOTAL FOR MAP NO. 32									199	*				38,090	29,913	
TOTAL FOR PROJ NO. 2017CPT.08.18.20832									2,555	1	562	349	12	480,992	340,543	
821,535																
GRAND TOTAL									47.12	1	562	349	12	981,116	733,299	
1,714,415																

SIGNING FOR ASPHALT SURFACE TREATMENT

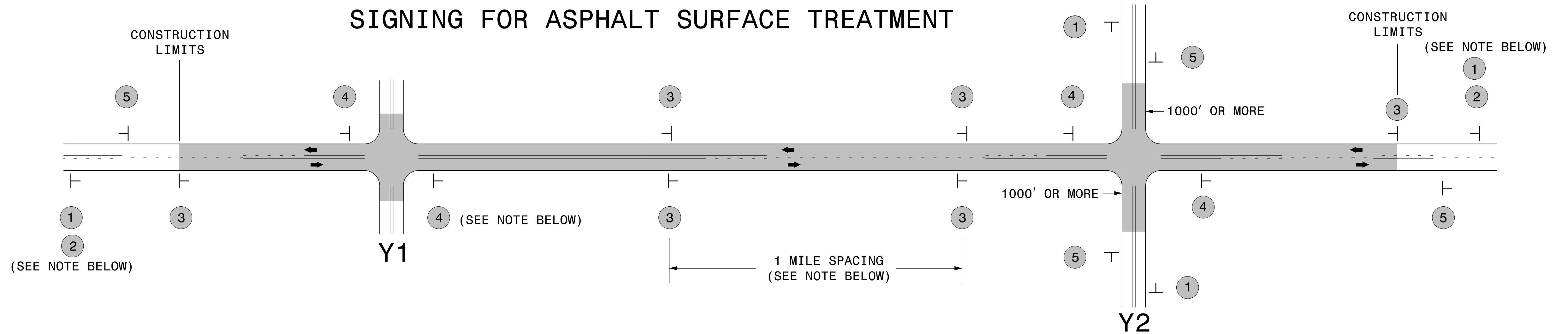

LEGEND	
┆	STATIONARY SIGN
←	DIRECTION OF TRAFFIC FLOW

MAINLINE (-L-) SIGNING

-Y- LINE SIGNING

SIGNING NOTES AND PLACEMENT PER DIRECTION	1	 <small>W20-1 48" X 48"</small>	PLACE 1000' PRIOR TO BEGINNING OF CONSTRUCTION LIMITS. ONLY USED ON -Y- LINES IF RESURFACING LIMITS EXTEND 1000' ALONG -Y- LINE.	<p style="text-align: center;">NO REQUIRED STATIONARY SIGNING FOR THE FOLLOWING -Y- LINE CONDITIONS:</p> <ol style="list-style-type: none"> 1) LESS THAN 1000' OF RESURFACING ALONG -Y- LINE 2) SUBDIVISION ROADS 3) DEAD END ROADS <p style="text-align: center;">WHEN PAVING/CONSTRUCTION ACTIVITIES PROCEED ACROSS AN UNSIGNED -Y- LINE, ADVANCE WARNING PORTABLE SIGNS SHALL BE USED ALONG THE -Y- LINE AS SHOWN BELOW. REMOVE UPON COMPLETION OF WORK.</p> <div style="display: flex; justify-content: space-around; align-items: center;"> <div style="text-align: center;"> <small>W20-1 48" X 48"</small> </div> <div style="text-align: center;"> <small>W20-7 A 48" X 48"</small> </div> </div> <p style="text-align: center;">PLACED 500' IN ADVANCE OF FLAGGER. PLACED 250' IN ADVANCE OF FLAGGER.</p>
	2	 <small>W7-3aP 24" X 18"</small>	#2 SIGN ONLY USED WHEN RESURFACING LIMITS ARE 2 OR MORE MILES IN LENGTH. ROUND UP TO NEXT WHOLE NUMBER. (NO FRACTIONAL OR DECIMAL NUMBERS)	
	3	 <small>W8-7 48" X 48"</small> <small>SP 48" X 48"</small>	ALTERNATE THE FOLLOWING TWO SIGNS: STARTING WITH "LOOSE GRAVEL" (W8-7) FOLLOWED BY "UNMARKED PAVEMENT". PLACE INITIALLY AT THE CONSTRUCTION LIMITS AND SPACED 1 MILE APART THEREAFTER. IF NO -Y- LINES EXIST, PLACE 2ND SET 1/2 MILE FROM THE CONSTRUCTION LIMITS AND THEN SPACE 1 MILE THEREAFTER.	
	4	 <small>SP 13106 48" X 48"</small>	THESE ARE FOR -Y- LINES THAT ARE "THROUGH" ROADWAYS. DEAD END AND SUBDIVISION ROADS ARE NOT "THROUGH" ROADWAYS. INSTALL 500' +/- FROM EACH -Y- LINE APPROACH AS SHOWN ABOVE. FOR MULTIPLE -Y- LINES THAT ARE SEPARATED BY 0.25 MILES OR LESS, TREAT AS A SINGLE UNIT AND INSTALL WITHIN 500' OF EACH APPROACH. A MAXIMUM OF 2 SIGN SETS PER MILE. DO NOT INSTALL WHEN -Y- LINES ARE WITHIN 0.5 MILES FROM "END ROAD WORK" SIGN.	
	5	 <small>G20-2 A 48" X 24"</small>	PLACE 500' FOLLOWING THE END OF CONSTRUCTION LIMITS.	

DIVISION OF HIGHWAYS
STATE OF NORTH CAROLINA
DEPARTMENT OF TRANSPORTATION
WORK ZONE TRAFFIC CONTROL

**ADVANCE WARNING SIGNS
FOR
ASPHALT SURFACE TREATMENTS
2 LANE ROADWAYS**

12/22/2014 S:\TMU\WZTC\Apps\WorkZoneGeneral\ExternalWebPage\DesRes\Resurfacing\Resurfacing_AdvWarn_2Ln - AST.dgn User:rmgarr